

Apr 01, 2009 - 4:47pm
 P:\42000 - 42099\42081 2009 Mill & Fill - Pembina Hwy NB from Bison Drive to Chancellor Drive\Bid Opportunity\Addendum 1\ADDENDUM142081-SK-001 - Pembina - Bison to Chancellor.dwg - tab:SK-001

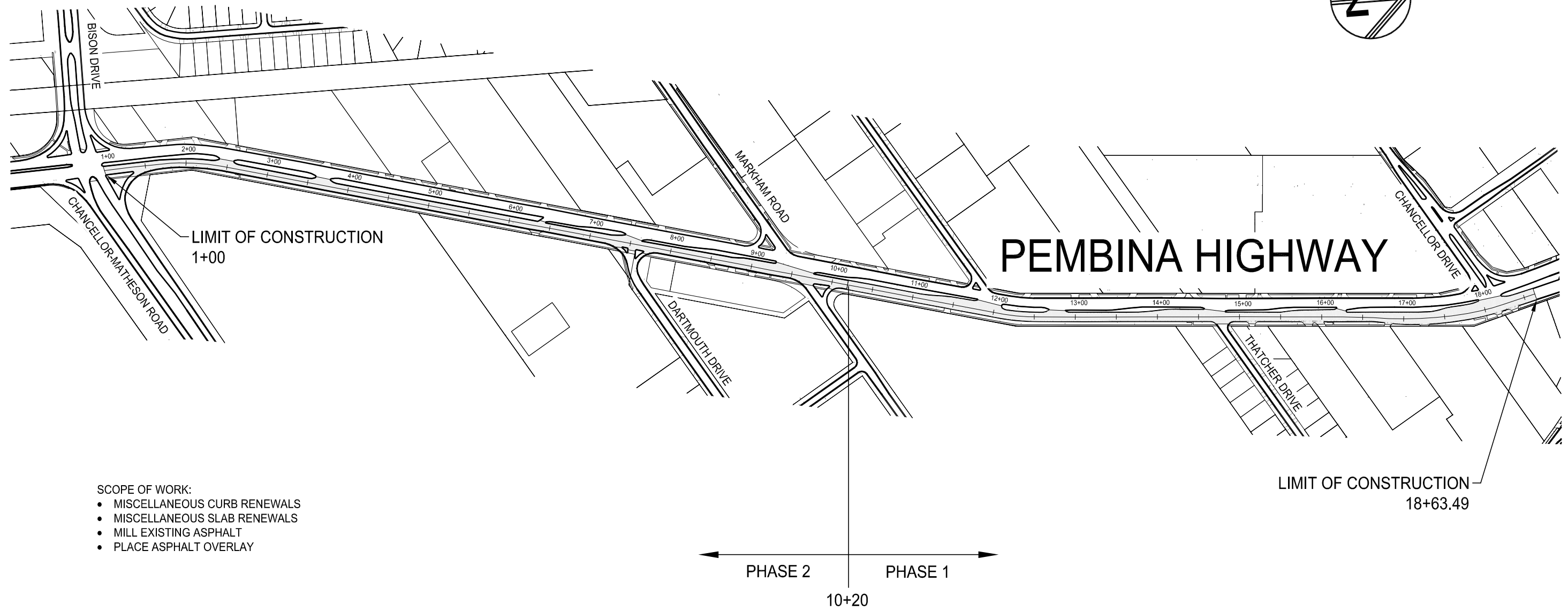

- SCOPE OF WORK:
- MISCELLANEOUS CURB RENEWALS
 - MISCELLANEOUS SLAB RENEWALS
 - MILL EXISTING ASPHALT
 - PLACE ASPHALT OVERLAY

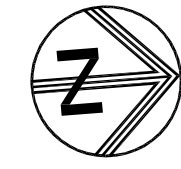
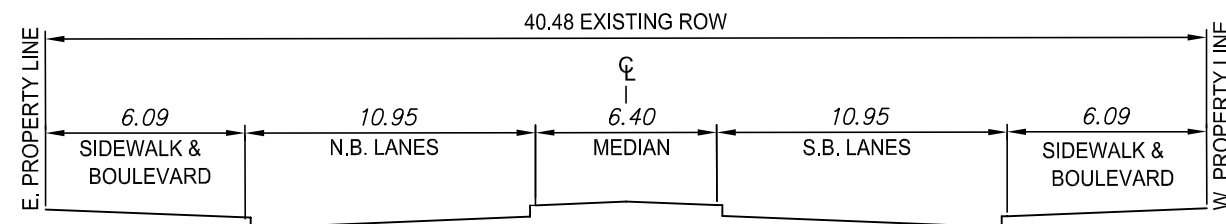

TYPICAL CROSS-SECTION
 SCALE: NTS

NOTE:
 These design documents are prepared solely for the use by the party with whom the design professional has entered into a contract and there are no representations of any kind made by the design professional to any party with whom the design professional has not entered into a contract.



MMM Group Limited
 Suite 111 - 93 Lombard Ave.
 Winnipeg, MB R3B 3B1
 t. 204.943.3178
 f. 204.943.4948
 www.mmm.ca

CITY OF WINNIPEG
 2009 REGIONAL STREETS MINOR ASPHALT REHABILITATION
 PEMBINA HIGHWAY - NORTHBOUND
 BISON DRIVE TO CHANCELLOR DRIVE

SCALE: NTS	DATE: FEB. 09/09	DWG. No. ADDENDUM 1-42081-SK-001
---------------	---------------------	-------------------------------------